

4151 NORTH SERVICE ROAD BURLINGTON, ONTARIO

207,465 S.F.
MULTI-TENANT
INDUSTRIAL BUILDING
FOR LEASE

INDUSTRIAL



For information, contact:

Steve Rawlin,
Vice President
Asset Management
T 416 798-5917
steve.rawlin@igri.com

Location:

North Service Road, Burlington,
east of Walkers Line

Date Available:

Immediate

Building Size(s):

207,465 s.f.

Unit Size(s) Available:

from ± 48,940 s.f.

Building Specifications:

Office Area: to suit (5% included)

Ceiling Height: 19' clear

Typical Bay Size: 40' x 40'

Shipping Doors:

Truck level and drive-in shipping

Construction:

Precast or block and metal construction

Sprinklers: Yes

Electrical: 3000 KVA

Site Size:

10.25 acres

Space Type:

Industrial Property (with office space)

Zoning:

6E1

Rental Rates From:

\$4.75 Net per s.f.

TMI (est.):

\$2.60 per s.f.

Comments:

- Expansion potential of 61,638 s.f.
- Good location
- Outside storage permitted



Income & Growth Realty Investments

www.igri.com

The information contained herein (the "Information") is intended for informational purposes only and should not be relied upon by recipients hereof. Although the Information is believed to be correct, its accuracy, correctness or completeness cannot be guaranteed. IG Realty Investments (IGRI) and its subsidiaries, associates and affiliates (collectively, "IGRI") neither guarantees, warrants nor assumes any responsibility or liability of any kind with respect to the accuracy, correctness, completeness, or suitability of, or decisions based upon or in connection with, the Information. The recipient of the Information should take such steps as the recipient may deem appropriate with respect to verifying or using the Information. Any agreements, conditions, guarantees, representations or warranties regarding the Information shall be limited strictly to those, if any, expressly contained in an agreement of purchase and sale or lease. The Information may change and any property described herein may be withdrawn from the market at any time without notice or obligations of any kind on the part of IGRI.

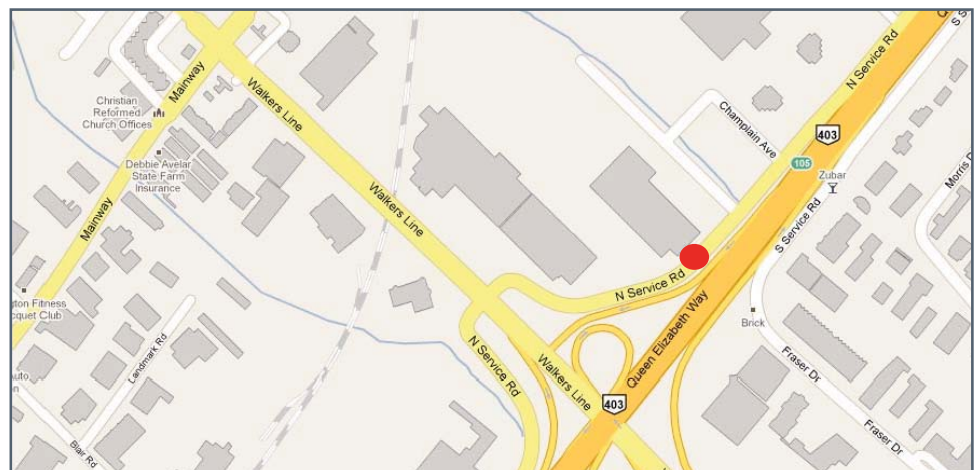

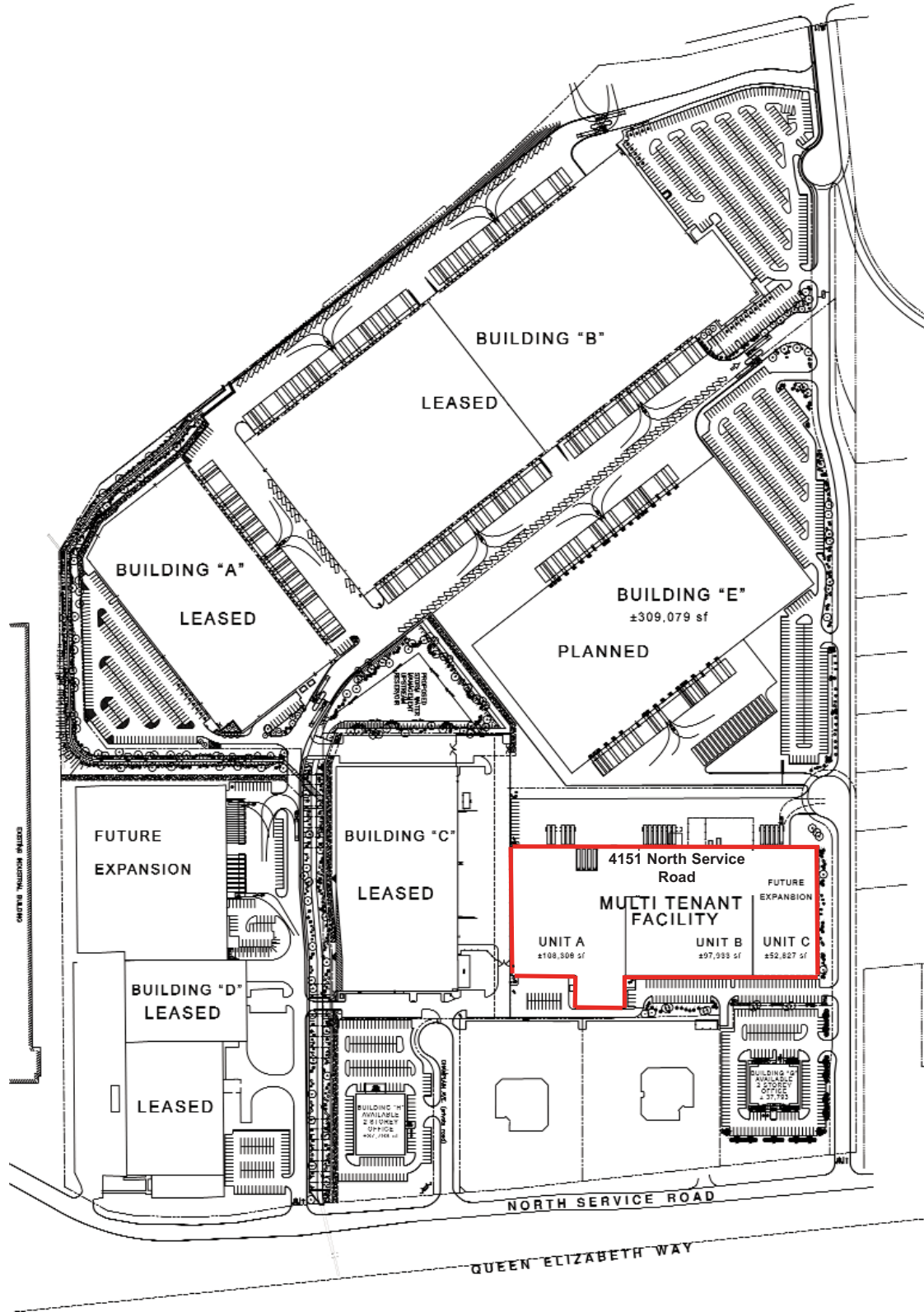

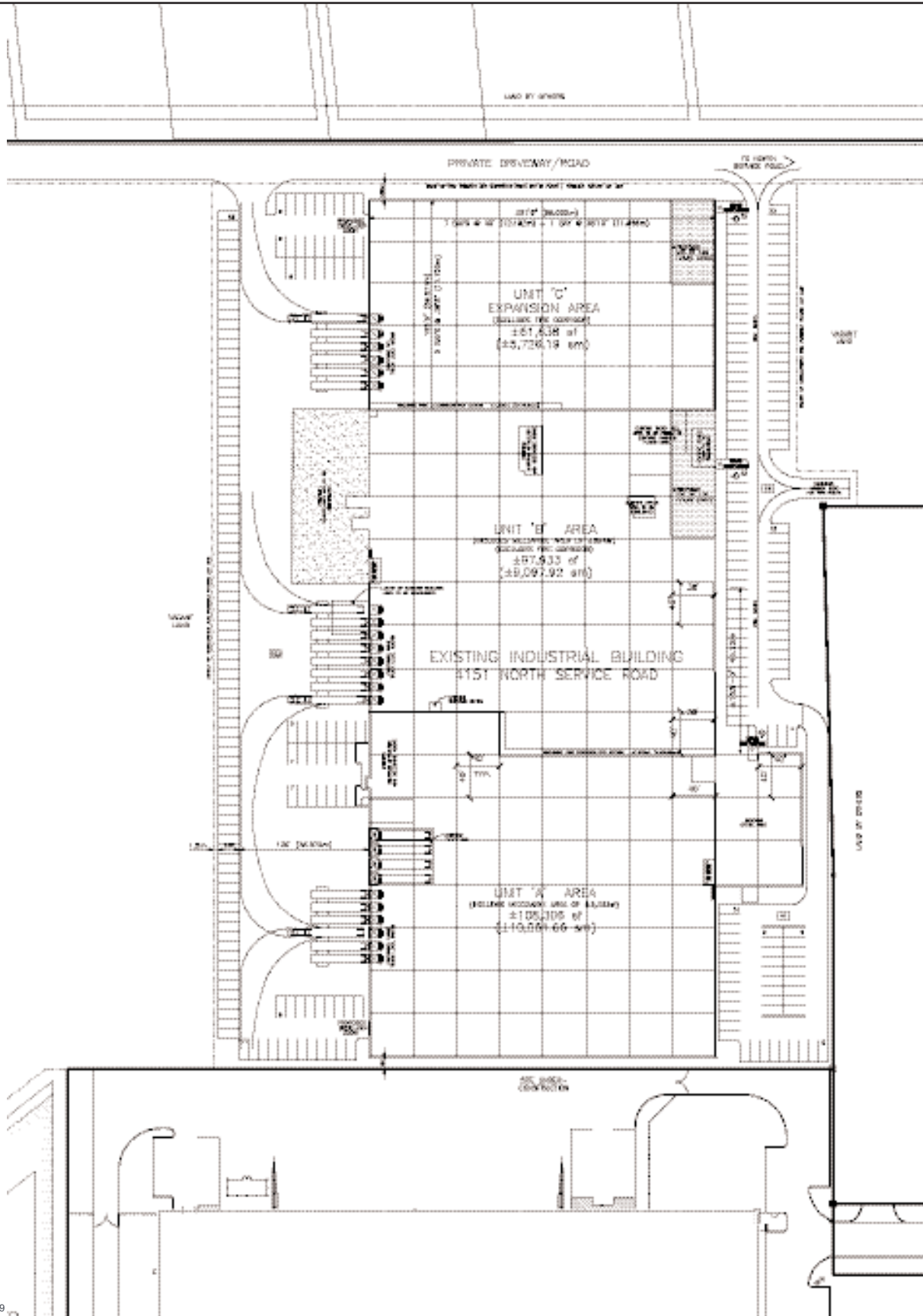

Modified: Nov, 2009

The information contained herein (the "Information") is intended for informational purposes only and should not be relied upon by recipients hereof. Although the Information is believed to be correct, its accuracy, correctness or completeness cannot be guaranteed. IG Realty Investments (IGRI) and its subsidiaries, associates and affiliates (collectively, "IGRI") neither guarantees, warrants nor assumes any responsibility or liability of any kind with respect to the accuracy, correctness, completeness, or suitability of, or decisions based upon or in connection with, the Information. The recipient of the Information should take such steps as the recipient may deem appropriate with respect to verifying or using the Information. Any agreements, conditions, guarantees, representations or warranties regarding the Information shall be limited strictly to those, if any, expressly contained in an agreement of purchase and sale or lease. The Information may change and any property described herein may be withdrawn from the market at any time without notice or obligations of any kind on the part of IGRI.